



Broad St. 2-way Full Street Closure

For outlying traffic control, see expanded view and detour plans.

Current plan is detailed for concrete placement staging, including flagmen.

SCI will provide written notification of concrete pour date to project neighbors within 300ft. Proposed date will be a Monday - Wednesday.

For general closure during standard working hours, SCI will notify Public Works (5) business days in advance.

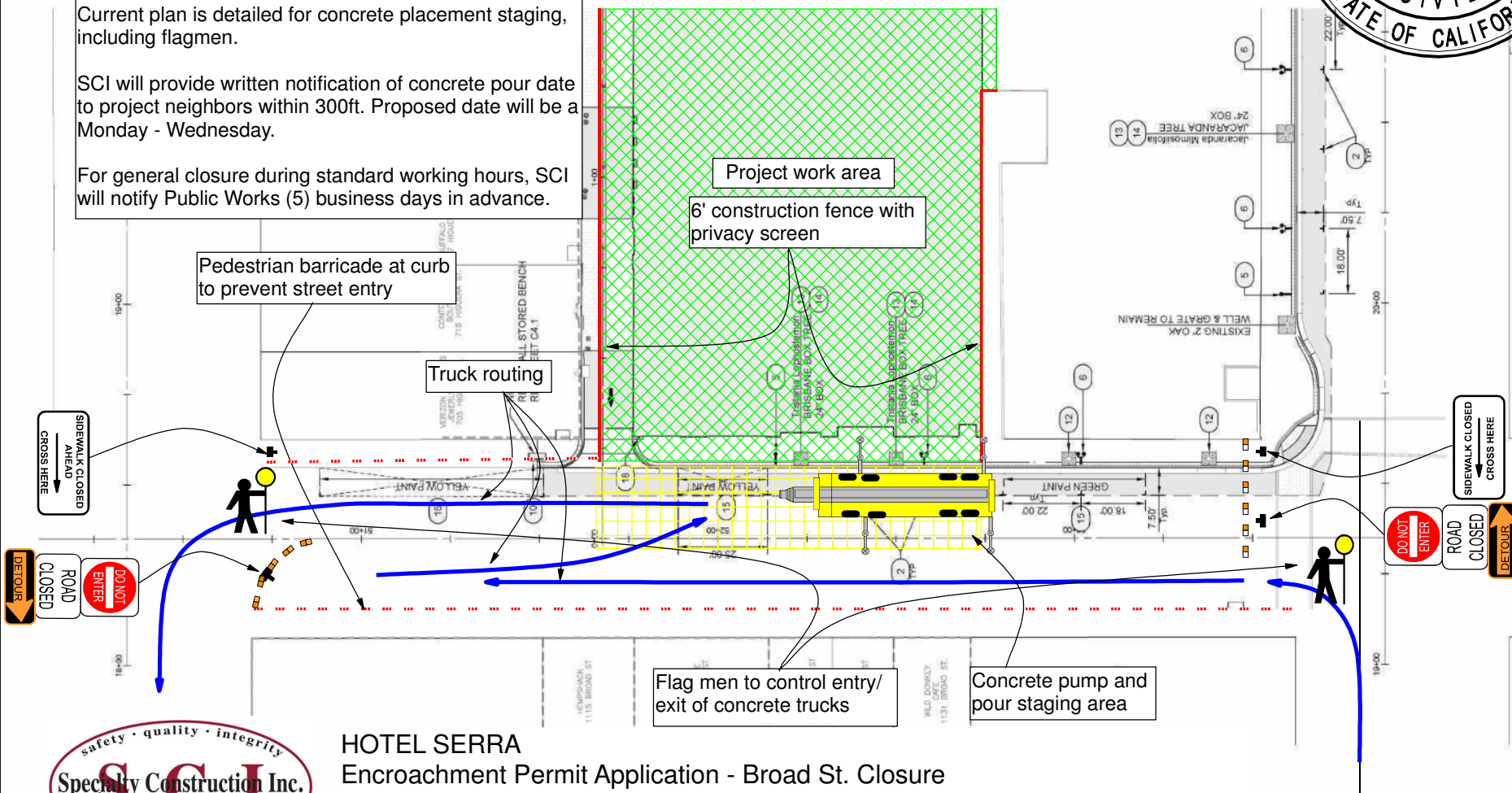

Flag men to control entry/exit of concrete trucks

Concrete pump and pour staging area



HOTEL SERRA
 Encroachment Permit Application - Broad St. Closure
 Specialty Construction, Inc.
 6/8/16

Broad St. 2-way Full Street Closure - Detour

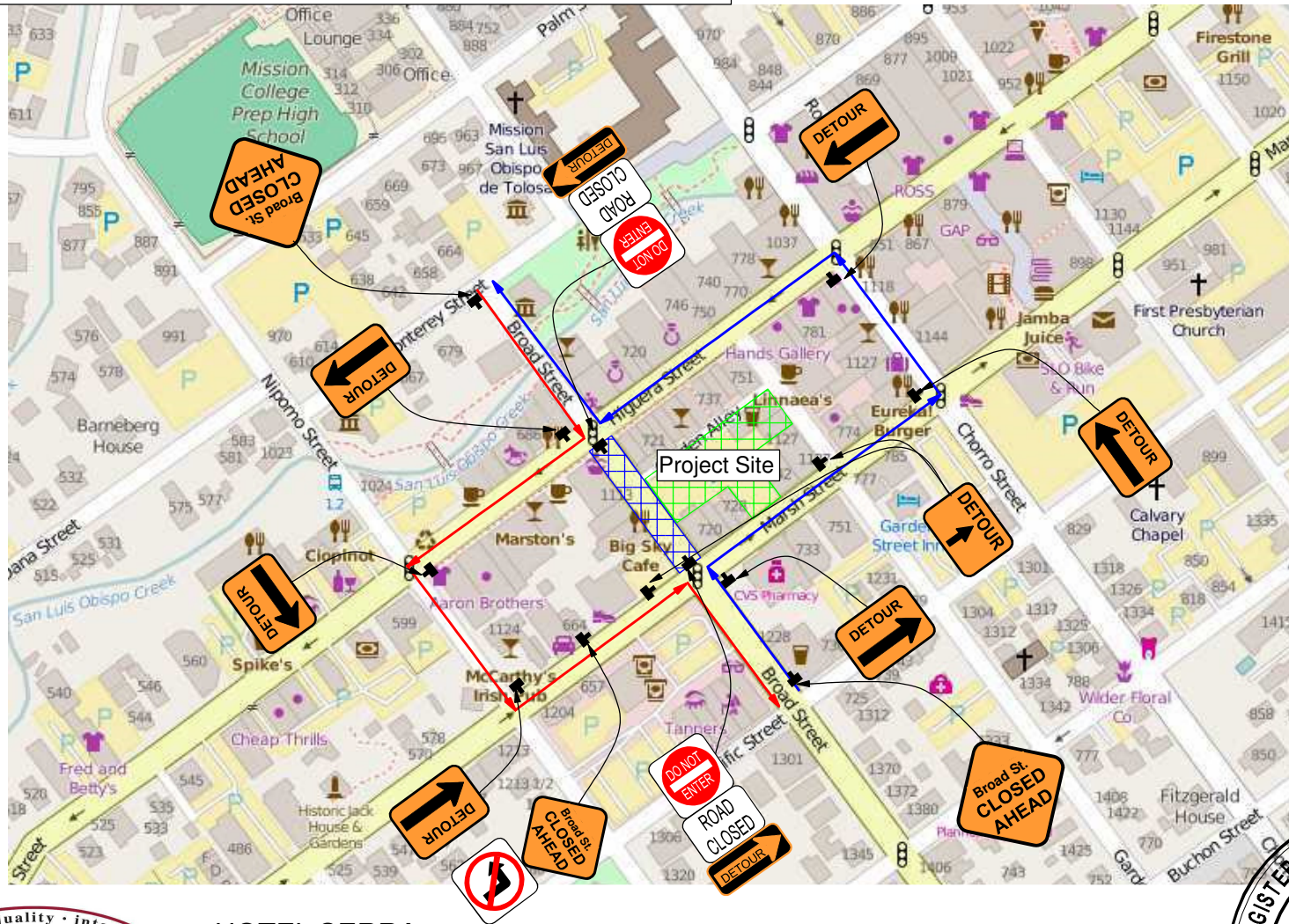

HOTEL SERRA
Encroachment Permit Application - Broad St. Closure
Specialty Construction, Inc.
6/8/16



Broad St. 2-way Full Street Closure - Marsh St. Measures

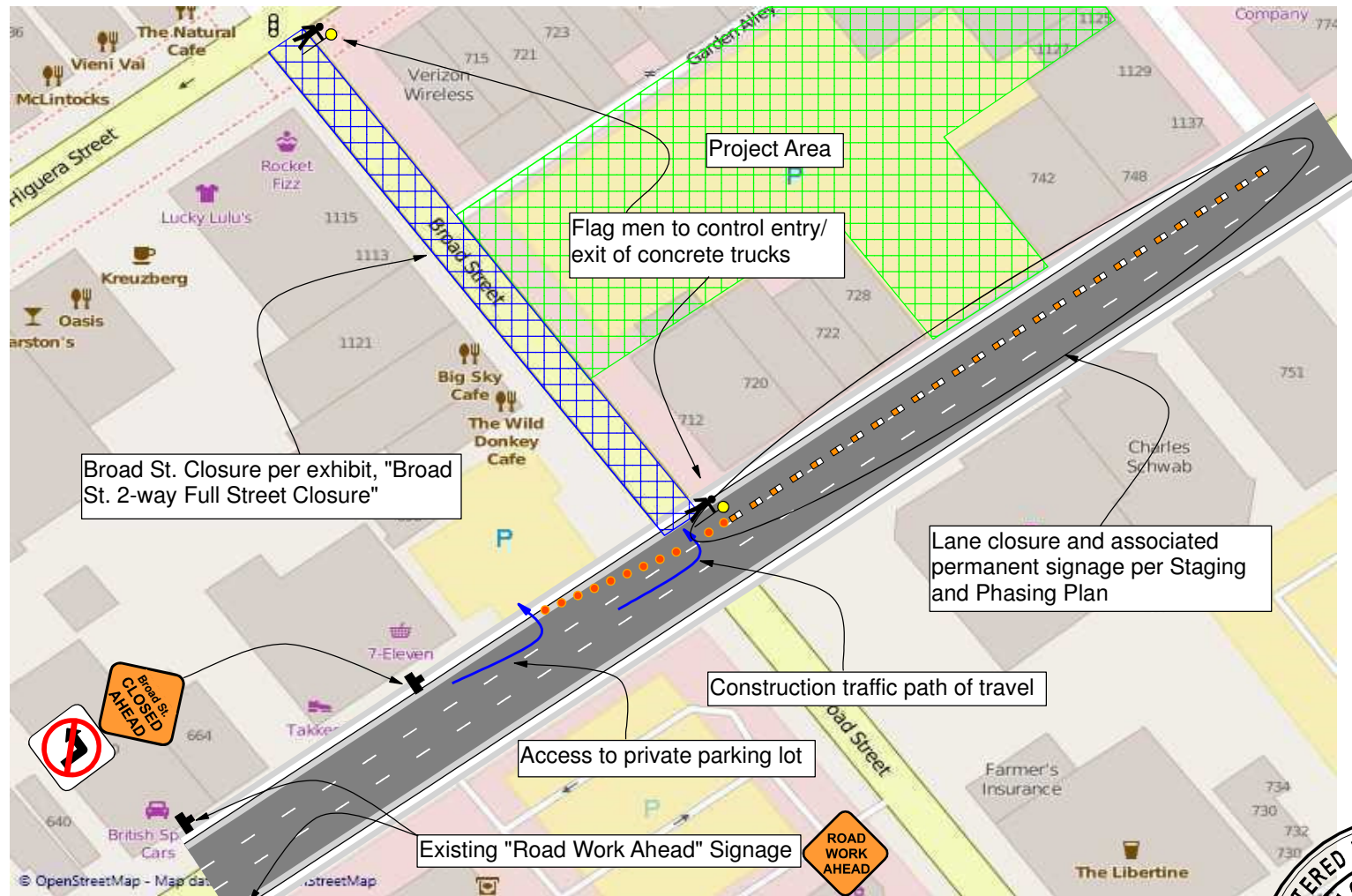

HOTEL SERRA
Encroachment Permit Application - Broad St. Closure
Specialty Construction, Inc.
6/8/16

